

Piab BGX suction cup



- Perfect for picking flimsy bags.
- The thin lip seals outstandingly even at low vacuum levels.
- The one-piece cup provides safe and stable hold of the product in fast/semi-fast robot applications.
- Multi Bellow design compensates for height differences and uneven surfaces.
- The silicone material complies with FDA 21 CFR 177.2600 & EU 1935/2004.
- Suitable for both high and low temperature applications.
- Configurable for individual applications in e-commerce, FMCG, secondary food picking, fashion, and other industries.

Lifting force

Description	Vertical		Parallel	
	12 -inHg	18 -inHg	12 -inHg	18 -inHg
Lifting forces	6.9 lbf	10.2 lbf	2.1 lbf	3.1 lbf

Technical data

Description	Unit	Value
Internal volume	in ³	1.95
Weight	oz	1.16
Min. curve radius -60 kPa	in	2.17
Max. vertical movement	in	1.08
Application	-	Bag handling
Material	-	Silicone (SIL FDA)
Colour	-	Blue
Suction cup model	-	BGX
Suction cup size	in	Ø 48mm
Suction cup shape	-	Multibellows
Hardness	°Shore A	50 °Shore A
Temperature range	°F	-4 – 392
Actuated outer diameter, max	in	2.01

Fitting specification

Description	Value
Fitting size	1/8"
Fitting style	Male
Fitting type	G-Thread
Fitting material	Al, NBR
Fitting option	None

Material resistance, Silicone FDA, SIL FDA

Description	Value
Alcohol	Good
Concentrated acids	Poor
Ethanol	N/A
Hydrolysis	Fair
Methanol	N/A
Oil	Poor
Oxidation	Excellent
Petrol	Poor
Wear resistance	Good
Weather & ozone	Excellent

Dimensional drawing

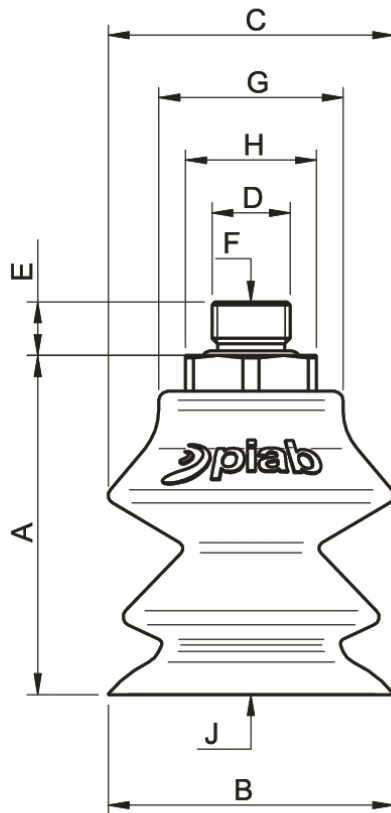

Pos.	Description	Unit	Value
A	Building height	mm [inch]	57.0 [2.24"]
B	Diameter (lip)	mm [inch]	48.0 [1.89"]
C	Diameter (bellows)	mm [inch]	48.0 [1.89"]
D	Thread	-	G1/8"
E	Thread height	mm [inch]	6.0 [0.24"]
G	Diameter (upper part cup)	mm [inch]	31.0 [1.22"]
H	Keygrip	mm	SW 23
J	Hex/torx grip	mm	SW 10

Ordering information – Current configuration

Description BGX suction cup	Product code S.BGX48SF50.G18M.00
Suction cup size	Ø 48mm
Suction cup material	Silicone FDA, SIL FDA
Hardness	50 °Shore A
Fitting type	G-Thread
Fitting size	1/8"
Fitting style	Male
Options	None

Ordering information, spare parts

Description	Art. No.
Suction Cup BGX48	9965206
Fitting G1/8" male cpl.	0233177

Ordering information, accessories

Description	Art. No.
Fitting 1/8"-27 NPSF female	0233170
Fitting G1/4" female	0233173
Fitting G3/8" female	0233443
Fitting G1/4" male cpl.	0233172
Fitting G3/8" male cpl.	0233175



Internal volume



Max. vertical movement

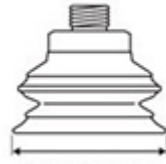

Diameter (lip)



Min. curve radius -60
kPa

Values specified in this data sheet are tested at (unless otherwise stated):

- Room temperature (20°C [68°F] ± 3°C [5.5°F]).
- Standard atmosphere (101.3 [29.9 inHg] ± 1.0 kPa [0.3 inHg]).
- Relative humidity 20-70%.
- Compressed air quality, DIN ISO 8573-1 class 4.

Storage guidelines (scan QR code):

